

**DIGITAL DOOR LOCK**

**D100**

# Product Guide

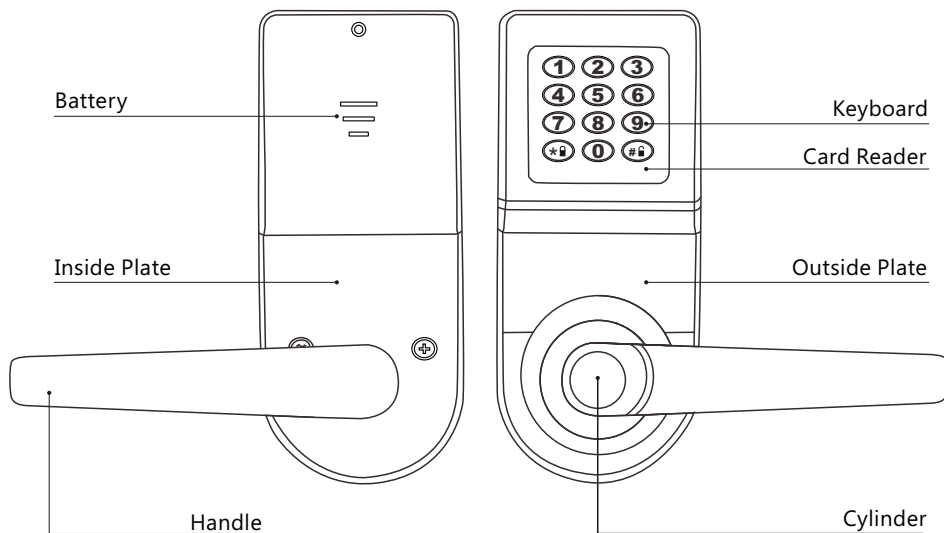

## Brief Introduction

- 1 There are 1 master user, 100 password users, and 800 card users available in the lock.
- 2 The default master user is "123-456". Only password user can be the master user.
- 3 The password length is 6 to 10 digits.
- 4 There are 2 unlocking modes in the lock:
  - a) Single Unlocking Mode: each time the lock only needs 1 registered user for unlocking;
  - b) Double Unlocking Mode: each time the lock needs 2 registered users for unlocking.
- 5 A low battery alarm will be activated when the battery's voltage is less than 4.8V. However, the lock still works about 200 times during this state. Please change the new batteries as soon as possible.

# Installation

*Nine times out of ten, an error is the result of an improper installation and/or wiring by the user. If you're not feeling particularly tech savvy, let a professional put it in.*

A

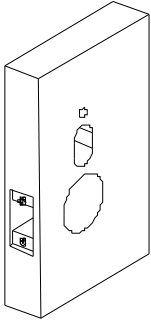

Mark the holes on the door according to the template, and then drill the holes.

B

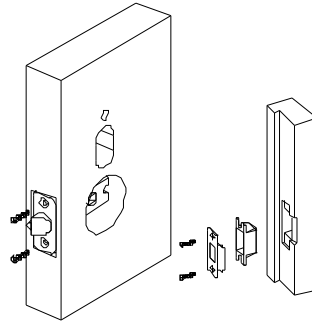

Install the latch and fasten it with screws. Install the strike box and fasten them with screws.

C

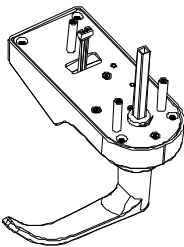

Install the spindle into the front panel, and then fasten it with the rod. Curve the rod on the side to make sure the installation is good. Then fasten 3 connection rods on the lock.

D

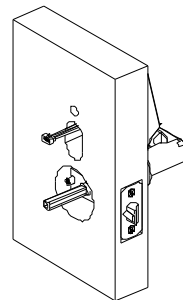

Put the plastic baseboard on the door, and then install the front panel. Check the cable and make it go through the door.

# Installation

E

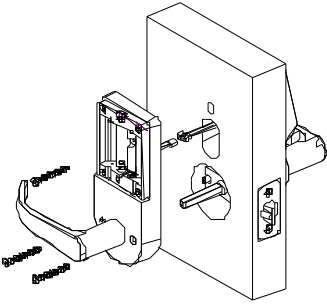

Put the plastic baseboard on the other side of the door, and then connect the cable with the back panel. Install the back panel on the door, and then fasten the lock with the screws.

F

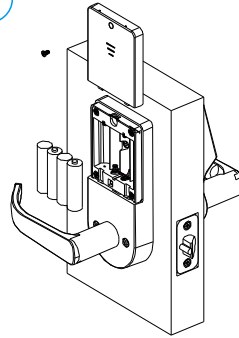

Install the batteries and check the lock.

G

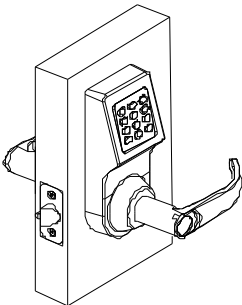

Try to unlock the lock to check the installation.

H

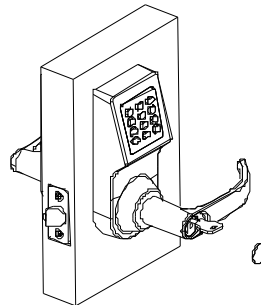

Take out the cylinder cover and try to use the key to unlock and check the installation.

# Operation

## 1 Password Unlocking

Touch the keypad to activate the lock, and then input the password with press “#” to finish. If the password is correct, the LED indicator shows green light with sounds, and then you can press down the handle for unlocking.

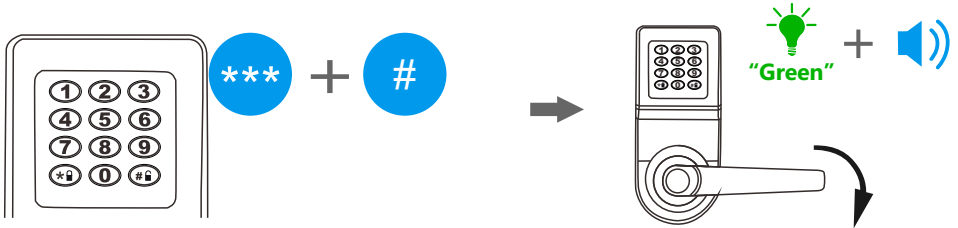

***If you input a wrong password for 5 times, the lock will be locked for 3 minutes. During the 3 minutes, the lock cannot be activated and all operations are not available. After that, the lock returns to normal state.***

## 2 RF Card Unlocking

Place the card close to keypad. If the card is correct, the LED indicator shows green light with sounds, and then you can press down the handle for unlocking.

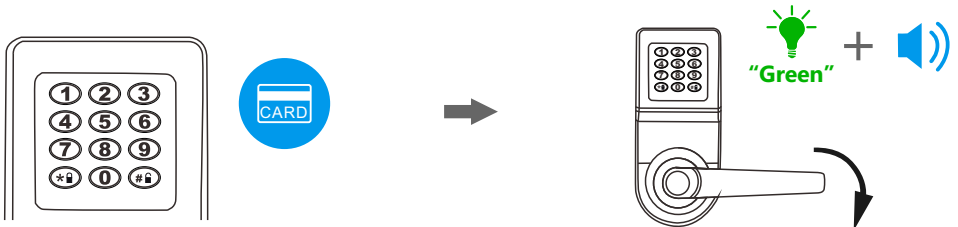

### 3 Mechanical Key Unlocking

When there are problems with electronic part, and the batteries run out of power using mechanical key is the way to unlock the lock.

Insert the mechanical key into the cylinder under the bottom of outside panel, and then turn the key 90 degree. After that, press down the handle for unlocking.

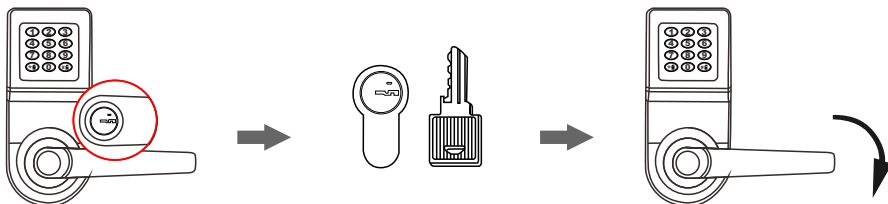

**The mechanical key cannot unlock the lock directly.**

### 4 Change The Master Password

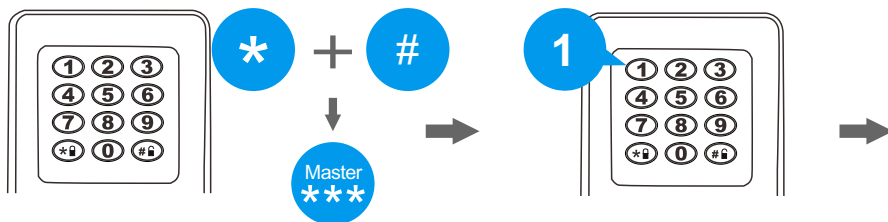

1.Input \* + #, and then input the master password to log in the system

2.Input 1

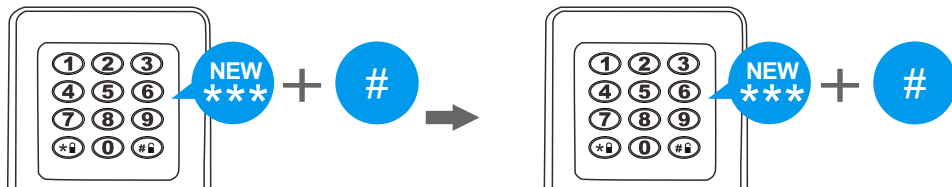

3.Input the new master password, press # to confirm

4.Input the new master password again, press # to confirm and finish the operation.



**The default master password is "123-456".**



**The length of password can be 6 to 10 digits.**



**Once finish the operations, please try to unlock the lock to confirm the operation is successful.**

## 5 Add Users (Password and Card)

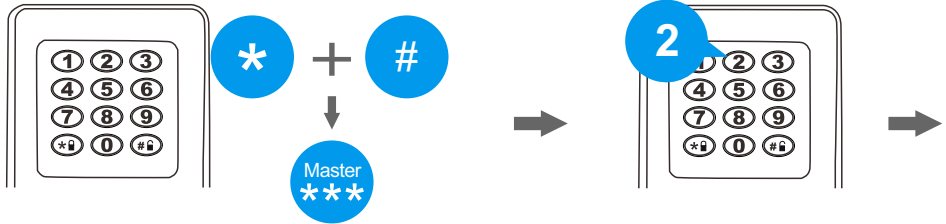

1.Input \* + #, and then input the master password to log in the system

2.Input 2

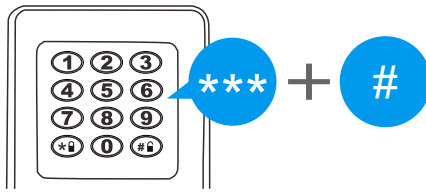

3.For Password User: input the password, and then press # to confirm and finish the operation.

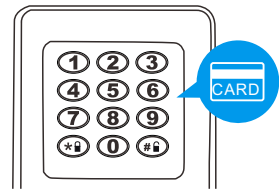

4.For Card User: put the card close to the lock and finish the operation



***The length of password can be 6 to 10 digits.***



***Once finish the operations, please try to unlock the lock to confirm the operation is successful.***

## 6 Delete Single User (Password or Card)

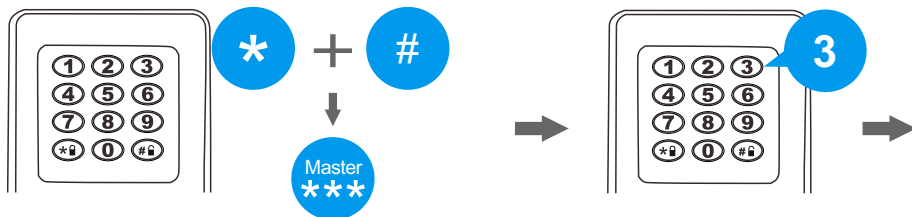

1.Input \* + #, and then input the master password to log in the system

2.Input 3

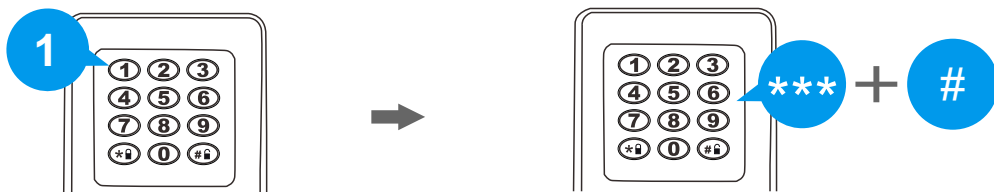

3.Input 1

4.Delete Password: input the password you want to delete, and press # to confirm

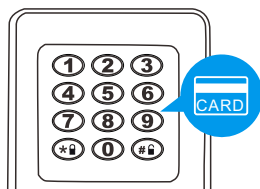

5.Delete Card: put the card close to the lock to delete.



**Once finish the operations, please try to unlock the lock to confirm the operation is successful.**



## 7 Delete All Users

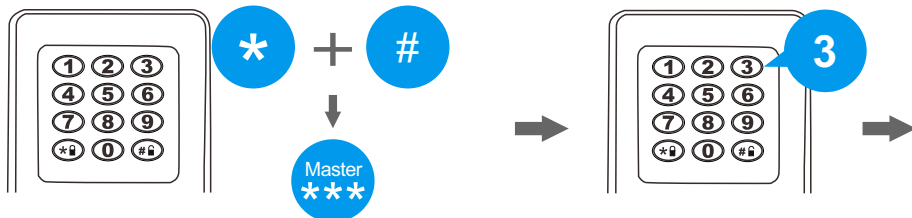

1.Input \* + #, and then input the master password to log in the system

2.Input 3

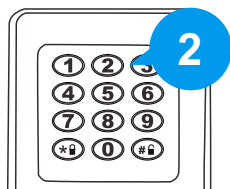

3.Input 2 to delete all normal users.



***This operation cannot delete the master user.***



***Once finish the operations, please try to unlock the lock to confirm the operation is successful.***

## 8 Passage Mode

When the lock is requested for unlocking frequently, you can activate the passage mode and let the people unlocking without identifications.

**Enable:**

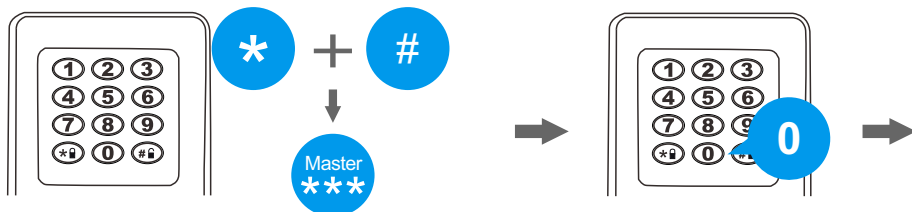

1.Input \* + #, and then input the master password to log in the system

2.Input 0

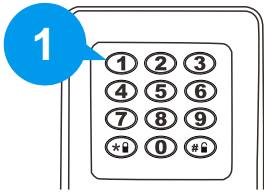

3.Input 1

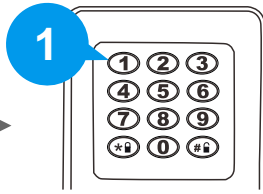

4.Input 1 to activate

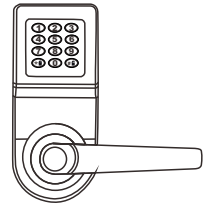

5.Unlock the lock and set the lock in passage mode.

## Disable:

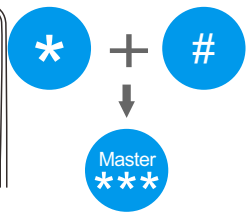
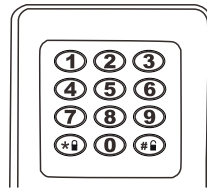
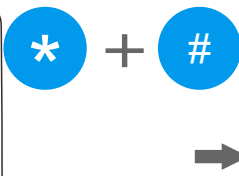
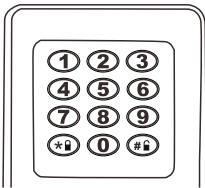

1.Input \* + # to turn off the passage mode.

2.Input \* + #, and then input the master password to log in the system

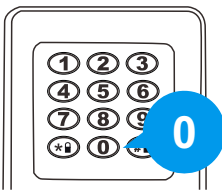

3.Input 0

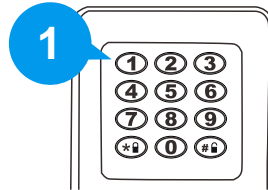

4.Input 1

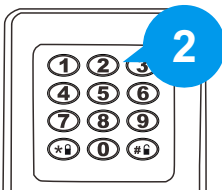

5.Input 2 to cancel.

# 9 Unlocking Mode

Sometime if you need a higher security level, you can set up the lock in double unlocking mode, which the unlock needs 2 registered users for unlocking each time.

## Single Unlocking Mode:

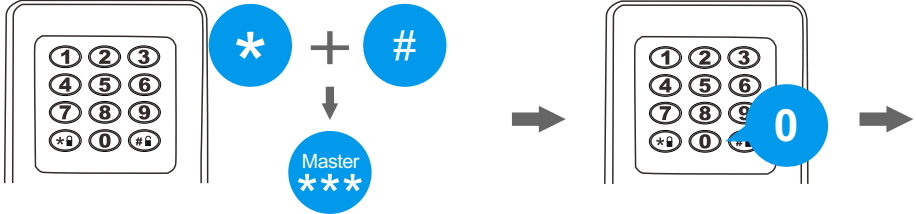

1.Input \* + #, and then input the master password to log in the system

2.Input 0

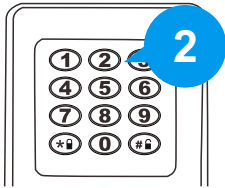

3.Input 2

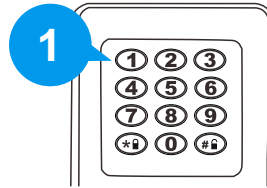

4.Input 1 for single unlocking mode.

## Double Unlocking Mode:

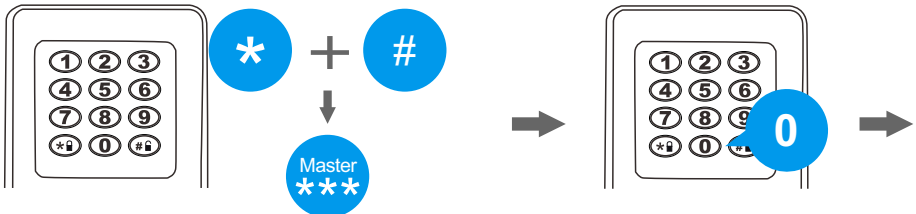

1.Input \* + #, and then input the master password to log in the system

2.Input 0

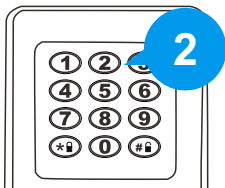

3.Input 2

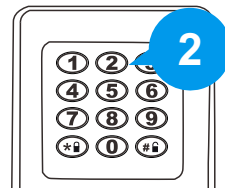

4.Input 2 for single double unlocking mode.



**When the lock is under double unlocking mode, you have to input 2 registered users to unlock every time. Those 2 users can be 2 password users, 2 card users, and 1 password user and 1 card user.**



**The master password user can unlock directly even the lock is under double unlocking mode.**



**Once finish the operations, please try to unlock the lock to confirm the operation is successful.**

## 10 Restore the Lock

When the lock has problems and you can try to restore the lock to solve the problems.

Press the restore key in the battery case for 6 seconds, then the lock starts to restore and finish with a buzzer sound. The mater password will be set as "123-456", please change the master password as soon as possible.

